



BFR Series

HOUSINGS
SINGLE BAG
LOW PRESSURE

MAIN APPLICATIONS:

- DESALINATION
- WATER TREATMENT
- FINE CHEMICAL
- FOOD & BEVERAGE
- POWER GENERATION
- PAINTS AND RESIN
- PHARMACEUTICAL
- MICROELECTRONIC
- GALVANIC
- HYDRAULIC
- STEEL MILL
- GENERAL INDUSTRY

CHARACTERISTICS:

- 100% AISI 316L construction.
- V-Clamp closure manufactured with lost wax micro-casting.
- Conform to 2014/68/UE PED Directive.
- Conform to 2014/34/UE ATEX Directive.
- 1935/2004/CE certification available upon request.
- Suitable for liquids Gr. 1 and 2 filtration.
- Side inlet bottom outlet nozzles design.
- Suitable for pressure up to 8 bar.
- Suitable for filtering bags size 1, 2, 3, 4.
- Suitable for filtering bags with metal ring and/or PolyformSEAL™.
- Suitable for high flow-rate and low spare cost.
- O-ring body/head seal.
- Restrainer suitable for Delta-P up to 4 bar
(10 bar Delta-P design available as option).
- 430-SS adjustable legs (option only for size 1 and 2).
- Hydraulic test on 100% of manufactured filters.
- Customization for OEM available.

ASCO FILTRI



ASCO Filtri S.p.A.

Viale delle Scienze, 8
20082 Binasco (MI) - Italy

Phone: +39 02 89703.1

Fax: +39 02 89703.410

E-mail: info@ascofiltri.com

Web: www.ascofiltri.com

BFR Series

HOUSINGS
SINGLE BAG
LOW PRESSURE

TECHNICAL DATA

MAX. WORKING CONDITION
8 bar @ 80 °C

CONSTRUCTION MATERIALS

BODY:

- 316L-SS

V-CLAMP:

- 316-SS micro casting

ADJUSTABLE LEGS:

- 430-SS (option)

FINISHING

- A38:

Internal electropolishing
External manual polishing

- A44:

Glass bead blasted

GASKETS

- EPDM *max. 120 °C*
- Viton *max. 230 °C*
- Silicone *max. 230 °C*
- FEP *max. 250 °C*

IN/OUT

- 1.1/2" GAS-M
- 2" GAS-M
- 2.1/2" GAS-M
- 3" GAS-M

VENT

- 3/8" GAS-F

ACCESSORIES

- Pressure gauge
- Vent valve
- Flanged connections
- Volume reducer
- Magnetic candles kit

OPTION

- Internal Halar coating
- Internal PFA coating

Dimensions:

Model	Q max.	Dimensions [mm]					In/out	Vol. [lt]	Weight [kg]	Fig.
	m³/h	A	B	C	D	E				
BFR013	9	114.3	95	-	257	60	1.1/2" Gas-m	2.6	8	2
BFR014	15	114.3	95	-	402	60	1.1/2" Gas-m	3.7	9	2
BFR011	20	204	170	[1]	479	120	2" Gas-m	16	26	1
BFR012	35	204	170	[1]	864	120	2" Gas-m	28	30	1

Max. flow-rate referred to 50 µm filtering bags. Initial Delta-P 0.1 bar. Fluid water.
Suggested flow-rate change according to the installed filtration rating.

1) "C" dimension adjustable, according to the selected model

FIG.1

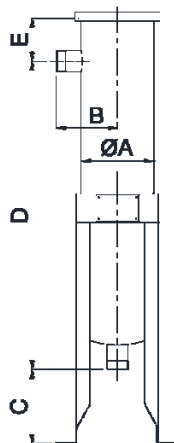
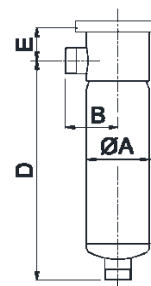

FIG.2



Max. working pressure:

Fluid	Model			
	BFR013	BFR014	BFR011	BFR012
Liquid Gr. 2	8 bar	8 bar	8 bar	8 bar
Liquid Gr. 1	8 bar	8 bar	8 bar	7 bar
Gas Gr. 2	Not suitable			
Gas Gr. 1				

Where the 2014/68/EU PED Directive is applicable, in case of dangerous liquids Gr. 1, the max. working pressure must be reduced. For different pressures contact ASCO Filtri.

Ordering information:

BFR	01	2	S	L	02	T	-	A38
	Bag qty: 01: 1			In/out position: L: side/bottom Z: side/side E: outlet w/ elbow		Nozzle type: T: GAS-M M: GAS-F F: EN flange A: ASME flange C: TriClover D: DIN 11851		Options: A38 A44
	Size: 1 2 3 4			In/out: 1H: 1.1/2" 02: 2" 2H: 2.1/2" 03: 3"				
	Material: S: 316L-SS							

We reserve the right to change the data of this specification without notice.

ASCO Filtri S.p.A.

Viale delle Scienze, 8
20082 Binasco (MI) - Italy
Phone: +39 02 89703.1
Fax: +39 02 89703.410
E-mail: info@ascofiltri.com
Web: www.ascofiltri.com

ASCO
FILTRI